

# TR 500A Mig/Mag Torch Range

Rating: 500A CO<sub>2</sub>, 350A mixed gas, EN60974-7 @ 60% duty cycle. 1.0 to 1.6mm / 0.040-1/16" wires

Air-Cooled Mig Welding Torch

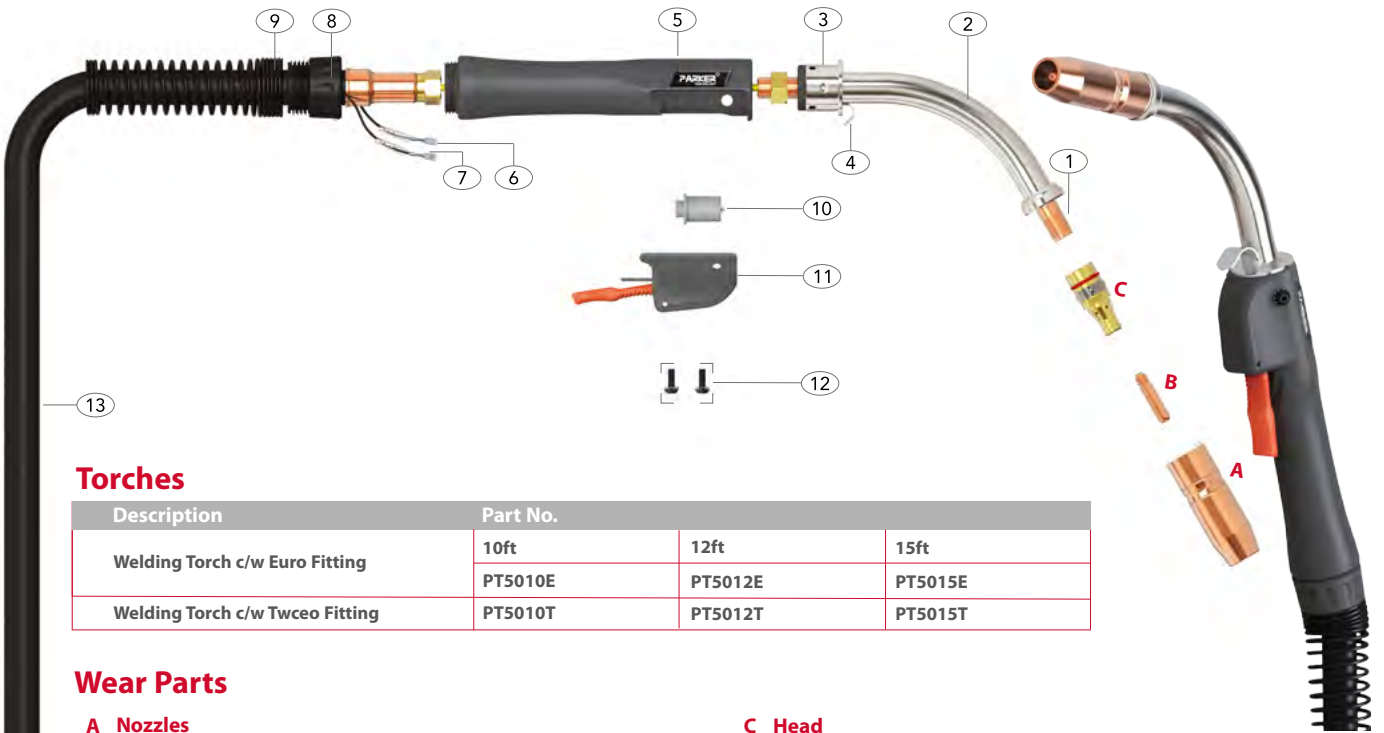

## Torches

| Description                     | Part No. |         |         |
|---------------------------------|----------|---------|---------|
|                                 | 10ft     | 12ft    | 15ft    |
| Welding Torch c/w Euro Fitting  | PT5010E  | PT5012E | PT5015E |
| Welding Torch c/w Twceo Fitting | PT5010T  | PT5012T | PT5015T |

## Wear Parts

### A Nozzles

| Part No.   | Description          | Bore | Wall   | Material |
|------------|----------------------|------|--------|----------|
| P401-4-38  | 1/8" Recess tip 3/8" | 9.50 | 2.25mm | Copper   |
| P401-4-50  | 1/8" Recess tip 1/2" | 12.7 | 2.25mm | Copper   |
| P401-4-62  | 1/8" Recess tip 5/8" | 16.0 | 2.25mm | Copper   |
| P401-4-75  | 1/8" Recess tip 3/4" | 19.0 | 2.25mm | Copper   |
| P401-5-50  | 1/4" Recess tip 1/2" | 12.7 | 2.40mm | Copper   |
| *P401-5-62 | 1/4" Recess tip 5/8" | 16.0 | 2.40mm | Copper   |
| P401-5-75  | 1/4" Recess tip 3/4" | 19.0 | 2.40mm | Copper   |
| P401-6-50  | 1/8" Recess tip 1/2" | 12.7 | 2.40mm | Copper   |
| P401-6-62  | 1/8" Recess tip 5/8" | 16.0 | 2.40mm | Copper   |
| P401-6-75  | 1/8" Recess tip 3/4" | 19.0 | 2.40mm | Copper   |

### B Contact Tips

| Part No.    | Description | Material | Wire Size |         |
|-------------|-------------|----------|-----------|---------|
|             |             |          | mm        | inch    |
| P403-10     | Contact Tip | Ecu      | 1.0       | 0.040   |
| P403-45     | Contact Tip | Ecu      | 1.2       | 0.045   |
| P403-52     | Contact Tip | Ecu      | 1.3       | 0.052   |
| P403-116    | Contact Tip | Ecu      | 1.6       | 1/16"   |
| P403-1-10   | Contact Tip | Ecu      | 1.0       | 0.040   |
| P403-1-45   | Contact Tip | Ecu      | 1.2       | 0.045   |
| P403-1-52   | Contact Tip | Ecu      | 1.3       | 0.052   |
| P403-1-55   | Contact Tip | Ecu      | 1.4       | 0.055   |
| *P403-1-116 | Contact Tip | Ecu      | 1.6       | 1/16"   |
| P403-1-364  | Contact Tip | Ecu      | 1.2A      | 3/64" A |
| P403-1-564  | Contact Tip | Ecu      | 2.0       | 5/64"   |

### C Head

| Part No. | Description             | Material |
|----------|-------------------------|----------|
| P402-3   | Retaining Head Assembly | Brass    |
| *P404-3  | Retaining Head Assembly | Brass    |

### D Liners

| Part No.      | Description        | Length | Wire Size |             |
|---------------|--------------------|--------|-----------|-------------|
|               |                    |        | mm        | inch        |
| P415-35-10B   | Steel Liner x 10ft | 3.80mt | 0.9-1.2   | 0.035-0.045 |
| P415-35-15B   | Steel Liner x 15ft | 4.90mt | 0.9-1.2   | 0.035-0.045 |
| *P415-116-10B | Steel Liner x 10ft | 3.80mt | 1.2-1.6   | 0.045-1/16" |
| *P415-116-15B | Steel Liner x 15ft | 4.90mt | 1.2-1.6   | 0.045-1/16" |

## Spare Parts

| Part No. | Description                           |
|----------|---------------------------------------|
| 1        | P402-5 Shock Washer                   |
| 2        | P305-60 Swan Neck Assembly            |
| 3        | P407 Torch Body Assembly              |
| 4        | PB2517 Hanger Hook                    |
| 5        | PRA30017K Handle Assembly             |
| 6        | PB1521 Cable Terminal                 |
| 7        | PB1521-C Cable Terminal Cover         |
| 8        | PRA50017F Lock Nut                    |
| 9        | PTR8019 Cable Support - Large Handle  |
| 10       | P411-1 Trigger Switch                 |
| 11       | PRA30017Q Switch Housing c/w Trigger  |
| 12       | P411-3 No.10-32 UNF Screws c/w Washer |
| 13       | P513-10 Cable Assembly x 10ft         |
|          | P513-12 Cable Assembly x 12ft         |
|          | P513-15 Cable Assembly x 15ft         |

\*Denotes torch package standard wear part set-up  
For more information please refer to the following sections:  
•Master Wear Parts Table Page 12-14  
•Rear-End / Cable Parts Page 15-17

